



“WE MAKE THE KITCHEN BETTER!”

ATOSA USA, INC.

Toll Free: 855-855-0399 Email: info@atosausa.com

www.atosa.com | www.atosausa.com

California, Colorado, Florida, Georgia, Illinois,
New Jersey, Ohio, Texas, Washington

Pizza Locker

Standard Features

- Floor mounted with (4) FootMaster casters
- 7 lockers
- Overall heating base, preset temperature is 150°F, adjustable range 90°F – 200°F
- 10” touchscreen on both operator and customer side
- Each locker will hold prepared and packaged food for up to 45 minutes, the timer can be changed
- Each locker has an infrared sensor device to detect whether the food has been put in and taken out
- Auto open & closing glass door with anti-pinch feature
- Add-on beverage locker and ambient storage locker

MODELS:

YBF9271



Customer Side



Operator Side



2 YEAR PARTS AND LABOR WARRANTY
5 YEAR COMPRESSOR PART WARRANTY





"WE MAKE THE KITCHEN BETTER!"

ATOSA USA, INC.

Toll Free: 855-855-0399 Email: info@atosausa.com

www.atosa.com | www.atosausa.com

California, Colorado, Florida, Georgia, Illinois,

New Jersey, Ohio, Texas, Washington

SPECIFICATIONS

Models	Door	Capacity (Cu.Ft.)	Voltage (V/Hz)	Power (W)	Rated Current (A)	Max Load Per Locker (lb)	Temperature Range (°F)	Exterior Dimensions (inch)	Interior Dimensions Per Locker (inch)	Net Weight (lb)
YBF9271	7	18.3	115/60	1330	11	33	86-204	32 ^{7/8} ×83 ^{7/8} ×34 ^{1/4}	24×5 ^{1/8} ×26 ^{3/8}	509

PLAN VIEW

Interior Dimension:
24(W) x 5^{1/8}(H) x 26^{3/8}(D)

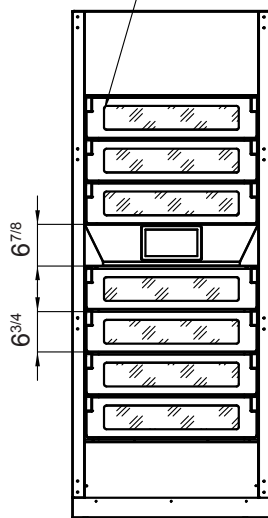

Customer Side

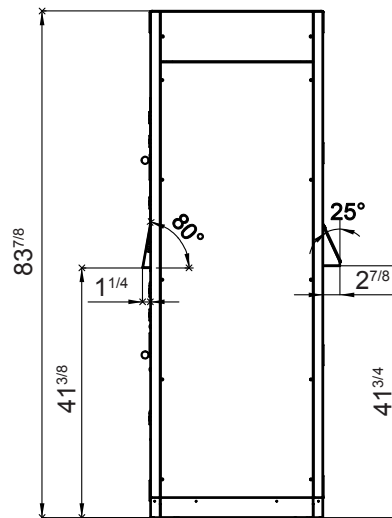

Side View

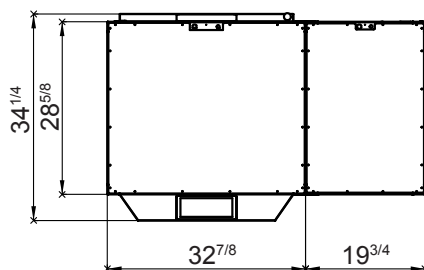

Top View

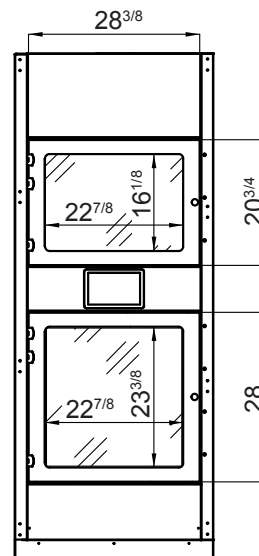

Operator Side

